

Thursday, August 06, 2020

**LOCATION**

<b>Property Address</b>	903 E Lytle St Murfreesboro, TN 37130-3908
<b>Subdivision</b>	University Hts Apts
<b>County</b>	Rutherford County, TN

**PROPERTY SUMMARY**

<b>Property Type</b>	Commercial
<b>Land Use</b>	Commercial
<b>Improvement Type</b>	Apartment
<b>Square Feet</b>	3598

**GENERAL PARCEL INFORMATION**

<b>Parcel ID/Tax ID</b>	0901 G 026.00
<b>Alternate Parcel ID</b>	0901 G 02600 00013090P
<b>Account Number</b>	R0053111
<b>District/Ward</b>	1
<b>2010 Census Trct/Blk</b>	416/4
<b>Assessor Roll Year</b>	2020

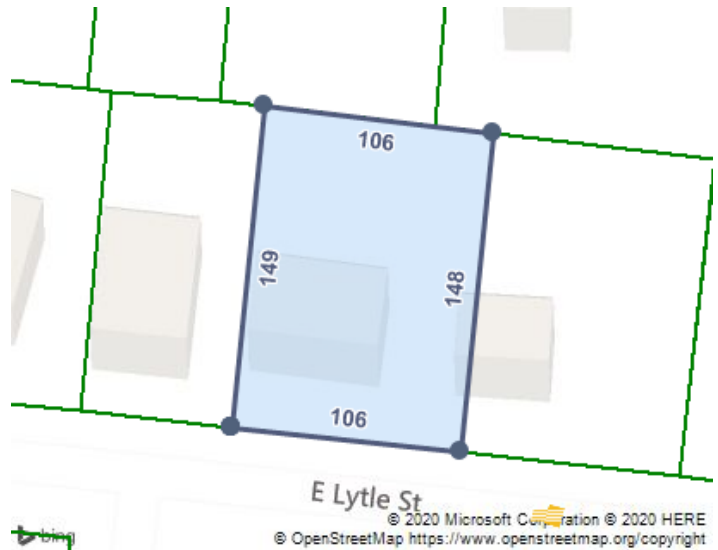

**TAX ASSESSMENT**

Appraisal	Amount	Assessment	Amount	Jurisdiction	Rate
<b>Appraisal Year</b>	2020	<b>Assessment Year</b>	2020	<b>Murfreesboro</b>	1.2894
<b>Appraised Land</b>	\$47,500	<b>Assessed Land</b>	\$19,000	<b>Rutherford</b>	2.2194
<b>Appraised Improvements</b>	\$210,100	<b>Assessed Improvements</b>	\$84,040		
<b>Total Tax Appraisal</b>	\$257,600	<b>Total Assessment</b>	\$103,040		
		<b>Exempt Amount</b>			
		<b>Exempt Reason</b>			

**TAXES**

Tax Year	City Taxes	County Taxes	Total Taxes
2019	\$1,328.60	\$2,286.87	\$3,615.47
2018	\$978.26	\$2,163.22	\$3,141.48
2017	\$910.26	\$2,021.79	\$2,932.05
2016	\$910.26	\$2,021.79	\$2,932.05
2014	\$910.26	\$1,875.97	\$2,786.23
2013	\$672.75	\$1,358.53	\$2,031.28

**PROPERTY CHARACTERISTICS: BUILDING**

**Building # 1**

<b>Type</b>	Apartment	<b>Condition</b>	Average	<b>Units</b>	4
<b>Year Built</b>	1948	<b>Effective Year</b>	1990	<b>Stories</b>	2
<b>BRs</b>		<b>Baths</b>	F H	<b>Rooms</b>	

**Total Sq. Ft.** 3,598

<b>Building Square Feet (Living Space)</b>	<b>Building Square Feet (Other)</b>
Base 1820	
Upper Story 1778	

**- CONSTRUCTION**

<b>Quality</b> Average	<b>Roof Framing</b> Hip/Gable
<b>Shape</b>	<b>Roof Cover Deck</b> Composition Shingle
<b>Partitions</b>	<b>Cabinet Millwork</b>
<b>Common Wall</b>	<b>Floor Finish</b> Wood Subfloor
<b>Foundation</b> 18 Block	<b>Interior Finish</b> Drywall
<b>Floor System</b>	<b>Air Conditioning</b>
<b>Exterior Wall</b> Frame Masonry Veneer	<b>Heat Type</b> Electric
<b>Structural Framing</b>	<b>Bathroom Tile</b>
<b>Fireplace</b>	<b>Plumbing Fixtures</b> 16

**- OTHER**

<b>Occupancy</b>	<b>Building Data Source</b> Owner
------------------	-----------------------------------

**PROPERTY CHARACTERISTICS: EXTRA FEATURES**

Feature	Size or Description	Year Built	Condition
Dcu	680	1956	POOR
Utl Bld	160	1984	POOR
Porch-Slab Roof Ceil	50		
Porch-Slab Roof Ceil	20		
Porch-Encl Solid Wal	128		
Porch-Encl Solid Wal	140		
Porch-Encl Solid Wal	140		
Porch-Encl Solid Wal	128		

**PROPERTY CHARACTERISTICS: LOT**

<b>Land Use</b> Commercial	<b>Lot Dimensions</b> 107 X 148
<b>Block/Lot</b> /O	<b>Lot Square Feet</b> 43,560
<b>Latitude/Longitude</b> 35.846978°/-86.376045°	<b>Acreage</b> 1

**PROPERTY CHARACTERISTICS: UTILITIES/AREA**

<b>Gas Source</b> Public	<b>Road Type</b> Urban Paved
<b>Electric Source</b> Public	<b>Topography</b> Rolling
<b>Water Source</b> Public	<b>District Trend</b> Static
<b>Sewer Source</b> Public	<b>Special School District 1</b>
<b>Zoning Code</b>	<b>Special School District 2</b>
<b>Owner Type</b> Private	

**LEGAL DESCRIPTION**

<b>Subdivision</b> University Hts Apts	<b>Plat Book/Page</b>
<b>Block/Lot</b> /O	<b>District/Ward</b> 1
<b>Description</b> 107 X 148	

**FEMA FLOOD ZONES**

<b>Zone Code</b>	<b>Flood Risk</b>	<b>BFE</b>	<b>Description</b>	<b>FIRM Panel ID</b>	<b>FIRM Panel Eff. Date</b>
X	Minimal		Area of minimal flood hazard, usually depicted on FIRMs as above the 500-year flood level.	47149C0260H	01/05/2007